



DHM9 INKREMENTÁLIS ÉRZÉKELŐ

DHM9-INKREMENTTIANTURI

- Felbontás max. 80 000 P / K
- IP 66 és IP67
- Kábel, csatlakozó vagy csatlakozó doboz
- Opcionális hajtómű



TERMÉKLEÍRÁS

MŰSZAKI ADATOK

Befoglalási átmérő	90 mm
Csatlakozás	Kábel, M23 érintkező
Érzékelő típusa	Differenciális
IP-osztály	IP66, IP67
Kilépés	Push/Pull
Max. impulzusszám	80000
Max. sebesség	9000 rpm
Max. tápfeszültség, DC	30 V DC
Max. tengelyátmérő	12 mm
Max. üzemi hőmérséklet	100 °C
Min. tápfeszültség, DC	5 V DC
Min. tengelyátmérő	11 mm
Min. üzemi hőmérséklet	-40 °C

ORDERING REFERENCE Contact the factory for special versions (over speed, electronics 5-30V, special flanges, connections...)

DIMAP	Shaft Ø	Square signals		Output signals	resolution	Connections	Orientation connection
		Electronics	Supply				
DBMP Stainless steel body	11-11mm	Electronics	252, P02, P02, SGT			GM03 12pin CW	A: axial R: radial
		Supply		G2 Output stages		GM03 12pin CW GM connection box G1 connector cable 4-pin	
DBMP Stainless steel cover and body	12-12mm	2 5Vdc	G2 driver 5Vdc: RS62	P: A,A/B,B/D2 (A&B gated)	94 000 max	G3 PVC cable 8-wires GP PUR cable 12-wires	Example R002 radial cable 2m A100 axial cable 10m
		C1 11mm length 20mm	5 11 to 30Vdc P: 5 to 30Vdc R: 4.75 to 30Vdc	G6 push-pull 5-30Vdc G7 push-pull 11-20Vdc transistorised			
		C2 12mm length 25mm					
		2 5Vdc	Wt. sine 1Vpp	Sine Wave output	9 15/C/C/2,2	5 000 max	
Ex. DIMAP	11 //	5	GS	9 //	94 000 //	GP	R050

Available resolutions (100°C electronic): 0 10 20 25 30 40 50 100 120 125 127 150 180 200 240 250 256 300 314 340 375 400 500 512 600 720 750 768 800 900 1000 1024 1200 1250 1280 1440 1600 1800 2000 2048 2400 2500 3000 3600 4000 4096 5000 6000 7200 8000 8192 10000

Interpolated available resolution (P/C electronic): 1000 2500 2880 3072 4000 5120 7500 8760 9000 10000 10800 12000 12500 12996 14400 15000 16000 16384 18000 20000 20480 24000 28800 30000 32000 32768 36000 40000 40960 42000 48000 49152 50000 57600 60000 64000 65536 80000 90000

Available resolutions sine-wave signals (100°C electronic): 250 256 300 300 1024 2500 5000

Sig A
Sig \bar{A}
Sig B
Sig \bar{B}
Sig Z
Sig \bar{Z}

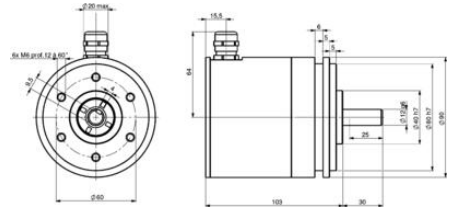
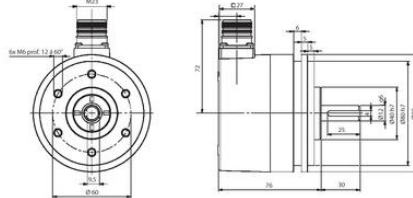
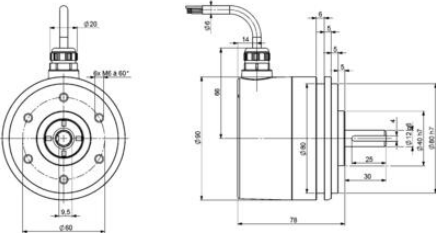
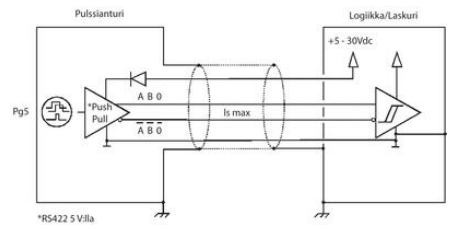
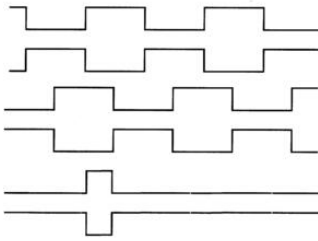

ORDERING REFERENCE Contact the factory for special versions (over speed, electronics 5-30V, special flanges, connections...)

DIMAP	Shaft Ø	Square signals		Output signals	resolution	Connections	Orientation connection
		Electronics	Supply				
DBMP Stainless steel body	11-11mm	Electronics	252, P02, P02, SGT			GM03 12pin CW	A: axial R: radial
		Supply		G2 Output stages		GM03 12pin CW GM connection box G1 connector cable 4-pin	
DBMP Stainless steel cover and body	12-12mm	2 5Vdc	G2 driver 5Vdc: RS62	P: A,A/B,B/D2 (A&B gated)	94 000 max	G3 PVC cable 8-wires GP PUR cable 12-wires	Example R002 radial cable 2m A100 axial cable 10m
		C1 11mm length 20mm	5 11 to 30Vdc P: 5 to 30Vdc R: 4.75 to 30Vdc	G6 push-pull 5-30Vdc G7 push-pull 11-20Vdc transistorised			
		C2 12mm length 25mm					
		2 5Vdc	Wt. sine 1Vpp	Sine Wave output	9 15/C/C/2,2	5 000 max	
Ex. DIMAP	11 //	5	GS	9 //	94 000 //	GP	R050

Available resolutions (100°C electronic): 0 10 20 25 30 40 50 100 120 125 127 150 180 200 240 250 256 300 314 340 375 400 500 512 600 720 750 768 800 900 1000 1024 1200 1250 1280 1440 1600 1800 2000 2048 2400 2500 3000 3600 4000 4096 5000 6000 7200 8000 8192 10000

Interpolated available resolution (P/C electronic): 1000 2500 2880 3072 4000 5120 7500 8760 9000 10000 10800 12000 12500 12996 14400 15000 16000 16384 18000 20000 20480 24000 28800 30000 32000 32768 36000 40000 40960 42000 48000 49152 50000 57600 60000 64000 65536 80000 90000

Available resolutions sine-wave signals (100°C electronic): 250 256 300 300 1024 2500 5000

Sig A
Sig \bar{A}
Sig B
Sig \bar{B}
Sig Z
Sig \bar{Z}

